

Screw Conveyor Hanger Bearings: Type 216

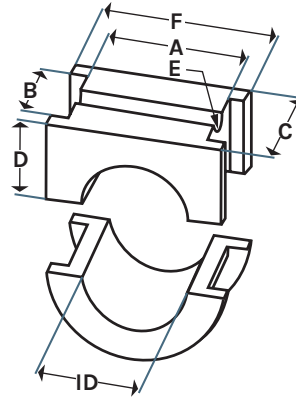

Used to support the rotating shaft in screw-conveying machinery. Ensures alignment, distributes weight, and provides smooth, low-friction rotation, even in applications involving abrasive or corrosive materials.

Fits hanger styles 216, 230, 316, 16B & 216F. Custom sizes available upon request.

Part No.	ID	A	B	C	D	E (Dia.)	F
WX1000-216	1"	1 ⁹ / ₁₆ "	1 ¹ / ₈ "	1 ⁷ / ₁₆ "	1"	7/16"	2"
WX1500-216	1 ½"	2 ¼"	1 ³ / ₈ "	1 ¹⁵ / ₁₆ "	1 ³ / ₈ "	9/16"	2 ¾"
WX2000-216	2"	3 ¼"	1 ⁵ / ₈ "	1 ¹⁵ / ₁₆ "	1 ⁵ / ₈ "	9/16"	3 ¾"
WX2716-216	2 ⁷ / ₁₆ "	4"	2 ³ / ₈ "	2 ¹⁵ / ₁₆ "	2 ¹ / ₈ "	9/16"	4 ½"
WX3000-216	3"	4 ½"	2 ¹ / ₈ "	2 ¹⁵ / ₁₆ "	2 ¼"	9/16"	5"
WX3716-216	3 ⁷ / ₁₆ "	4 ⁷ / ₈ "	2 ¹¹ / ₁₆ "	3 ¹⁵ / ₁₆ "	2 ⁷ / ₁₆ "	1 1/16"	5 ½"

MADE IN



To learn more and to find out if the **Screw Conveyor Hanger Type 216 Bearings** are right for you, please give us a call, or submit an online application today!

woodex-meco.com | +1 207.371.2210 | sales@woodex-meco.com

216 Bay Point Road, Georgetown, ME 04548 U.S. | © Woodex Bearing Company, Inc. 2025

